

HRC Coupling

Coupling Size	Power @ 100 RPM KW	Torque nm	Finish Bore		Ø A	Ø B	C	D	Ø E	F	G	L	Approx Weight Kg.
			Min.	Max.									
SHRC 70	0.33	31	10	38	69	60	20	24	31	26.0	18.0	66.0	1.000
SHRC 90	0.84	80	10	45	85	70	26	30	32	30.5	22.5	82.5	1.700
SHRC 110	1.68	160	10	65	112	100	37	45	45	45.0	29.0	119.0	5.000
SHRC 130	3.30	315	14	65	130	105	47	56	50	54.0	36.0	148.0	5.600
SHRC 150	6.28	600	19	75	150	115	50	60	62	60.0	40.0	160.0	7.300
SHRC 180	9.95	950	35	80	180	125	58	70	77	73.0	49.0	189.0	16.500
SHRC 230	20.90	2000	38	100	225	155	77	90	99	85.5	59.5	239.5	26.000
SHRC 280	33.00	3150	48	130	275	206	90	105	119	104.5	74.5	284.5	50.000

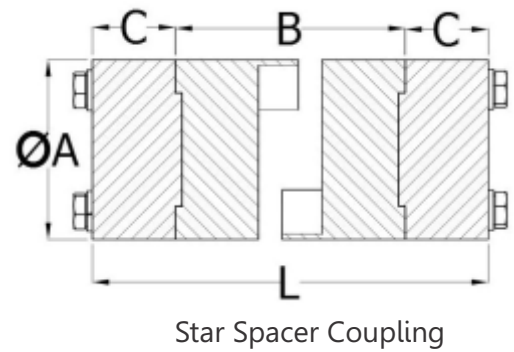
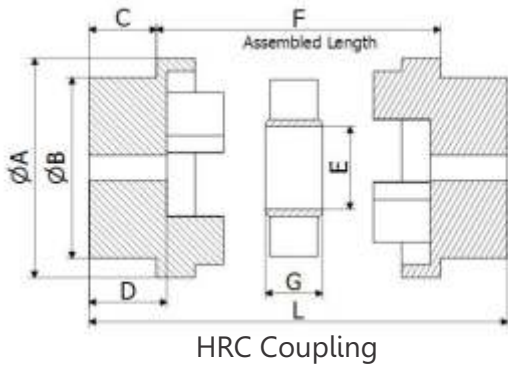

Star spacer coupling (RRL)

SIZE	BORE		Ø A	B	C	L	APPROX. WEIGHT IN KG						
SFSC 95	15	28	54	90	100	25	140	150			2.0	2.5	
SFSC 100	15	35	65	90	100	140	30	150	160	200	3.0	3.5	4.3
SFSC 110	20	42	85	90	100	140	35	160	170	210	5.8	6.3	8.0
SFSC 150	20	48	96	90	100	140	45	180	190	230	8.5	9.0	11.0
SFSC 190	30	55	115	90	100	140	51	192	202	242	12.5	13.5	16.0
SFSC 225	40	60	127	90	100	140	57	204	214	254	16.5	17.5	21.0
SFSC 226	40	65	130	100	140	180	60	220	260	300	23.2	27.5	32.0
SFSC 276	40	75	157	100	140	180	60	220	260	300	34	40.3	46.4
SFSC 280	40	85	190	100	140	180	65	230	270	310	52	61.2	70.3
SFSC 295	40	100	231	100	140	180	65	230	270	310	77.3	91	104.2

